



X-TREME SYSTEMS  
INSPIRATION THROUGH DESIGN



# GULVAIN

OVERSIZE STORAGE

DOWNLOAD 2D CAD FOR OUR PRODUCTS

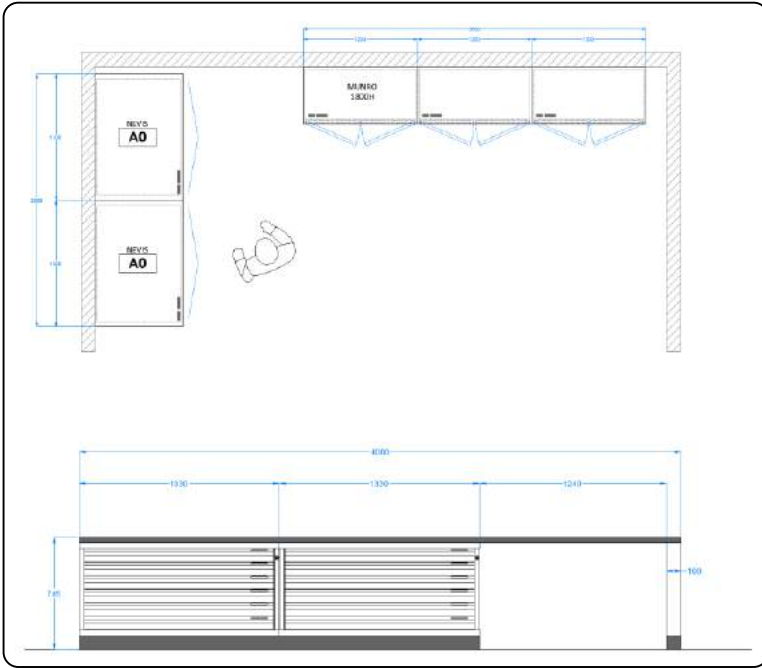

Planning aids,  
Front and plan views,  
All size and model configurations.

[www.x-tremesystems.com/downloads/](http://www.x-tremesystems.com/downloads/)

EXPLORE OUR OTHER RANGES FOR MUSEUM, ARCHIVE AND GALLERY STORAGE



## PRODUCT FEATURES

- High-quality steel construction
- Massive overall size allows for storage of oversize and irregular items
- Internal drawer height of 100mm
- Heavy duty runners allow for 75Kg per drawer
- Full extension runners
- Units can be ordered to any RAL colour finish

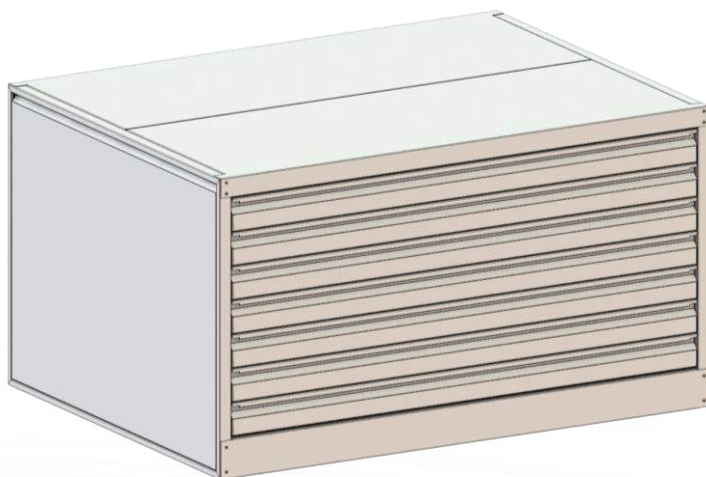

GULVAIN plan chests can also be tailored to meet individual briefs:

- Alternative drawer depths
- Two-tone finishing options
- Add-on worktops
- Special height requirements
- Additional product protection and display features

Popular RAL colour choices include:



PLEASE CONTACT US TO MAKE AN ENQUIRY OR TO DISCUSS YOUR CUSTOM GULVAIN BUILD.

# 1500W

## 1500 DEEP UNITS – DRAWER INTERNAL 1340 x 1380

100mm DRAWERS	WIDTH	DEPTH	HEIGHT	MODEL NO.
5	1500	1500	849	
6	1500	1500	973	
7	1500	1500	1097	
8	1500	1500	1221	
10	1500	1500	1469	

## 1750 DEEP UNITS – DRAWER INTERNAL 1340 x 1630

100mm DRAWERS	WIDTH	DEPTH	HEIGHT	MODEL NO.
5	1500	1750	849	
6	1500	1750	973	
7	1500	1750	1097	
8	1500	1750	1221	
10	1500	1750	1469	

## 2000 DEEP UNITS – DRAWER INTERNAL 1340 x 1880

100mm DRAWERS	WIDTH	DEPTH	HEIGHT	MODEL NO.
5	1500	2000	849	
6	1500	2000	973	
7	1500	2000	1097	
8	1500	2000	1221	
10	1500	2000	1469	

# 1750W

## 1500 DEEP UNITS – DRAWER INTERNAL 1590 x 1380

100mm DRAWERS	WIDTH	DEPTH	HEIGHT	MODEL NO.
5	1750	1500	849	
6	1750	1500	973	
7	1750	1500	1097	
8	1750	1500	1221	
10	1750	1500	1469	

## 1750 DEEP UNITS – DRAWER INTERNAL 1590 x 1630

100mm DRAWERS	WIDTH	DEPTH	HEIGHT	MODEL NO.
5	1750	1750	849	
6	1750	1750	973	
7	1750	1750	1097	
8	1750	1750	1221	
10	1750	1750	1469	

## 2000 DEEP UNITS – DRAWER INTERNAL 1590 x 1880

100mm DRAWERS	WIDTH	DEPTH	HEIGHT	MODEL NO.
5	1750	2000	849	
6	1750	2000	973	
7	1750	2000	1097	
8	1750	2000	1221	
10	1750	2000	1469	

# 2000W

## 1500 DEEP UNITS – DRAWER INTERNAL 1840 x 1380

100mm DRAWERS	WIDTH	DEPTH	HEIGHT	MODEL NO.
5	2000	1500	849	
6	2000	1500	973	
7	2000	1500	1097	
8	2000	1500	1221	
10	2000	1500	1469	

## 1750 DEEP UNITS – DRAWER INTERNAL 1840 x 1630

100mm DRAWERS	WIDTH	DEPTH	HEIGHT	MODEL NO.
5	2000	1750	849	
6	2000	1750	973	
7	2000	1750	1097	
8	2000	1750	1221	
10	2000	1750	1469	

## 2000 DEEP UNITS – DRAWER INTERNAL 1840 x 1880

100mm DRAWERS	WIDTH	DEPTH	HEIGHT	MODEL NO.
5	2000	2000	849	
6	2000	2000	973	
7	2000	2000	1097	
8	2000	2000	1221	
10	2000	2000	1469	

# 2250W

## 1500 DEEP UNITS – DRAWER INTERNAL 2090 x 1380

100mm DRAWERS	WIDTH	DEPTH	HEIGHT	MODEL NO.
5	2250	1500	849	
6	2250	1500	973	
7	2250	1500	1097	
8	2250	1500	1221	
10	2250	1500	1469	

## 1750 DEEP UNITS – DRAWER INTERNAL 2090 x 1630

100mm DRAWERS	WIDTH	DEPTH	HEIGHT	MODEL NO.
5	2250	1750	849	
6	2250	1750	973	
7	2250	1750	1097	
8	2250	1750	1221	
10	2250	1750	1469	

## 2000 DEEP UNITS – DRAWER INTERNAL 2090 x 1880

100mm DRAWERS	WIDTH	DEPTH	HEIGHT	MODEL NO.
5	2250	2000	849	
6	2250	2000	973	
7	2250	2000	1097	
8	2250	2000	1221	
10	2250	2000	1469	

